

700R4 SUPER SERVO INSTALLATION (92845A)

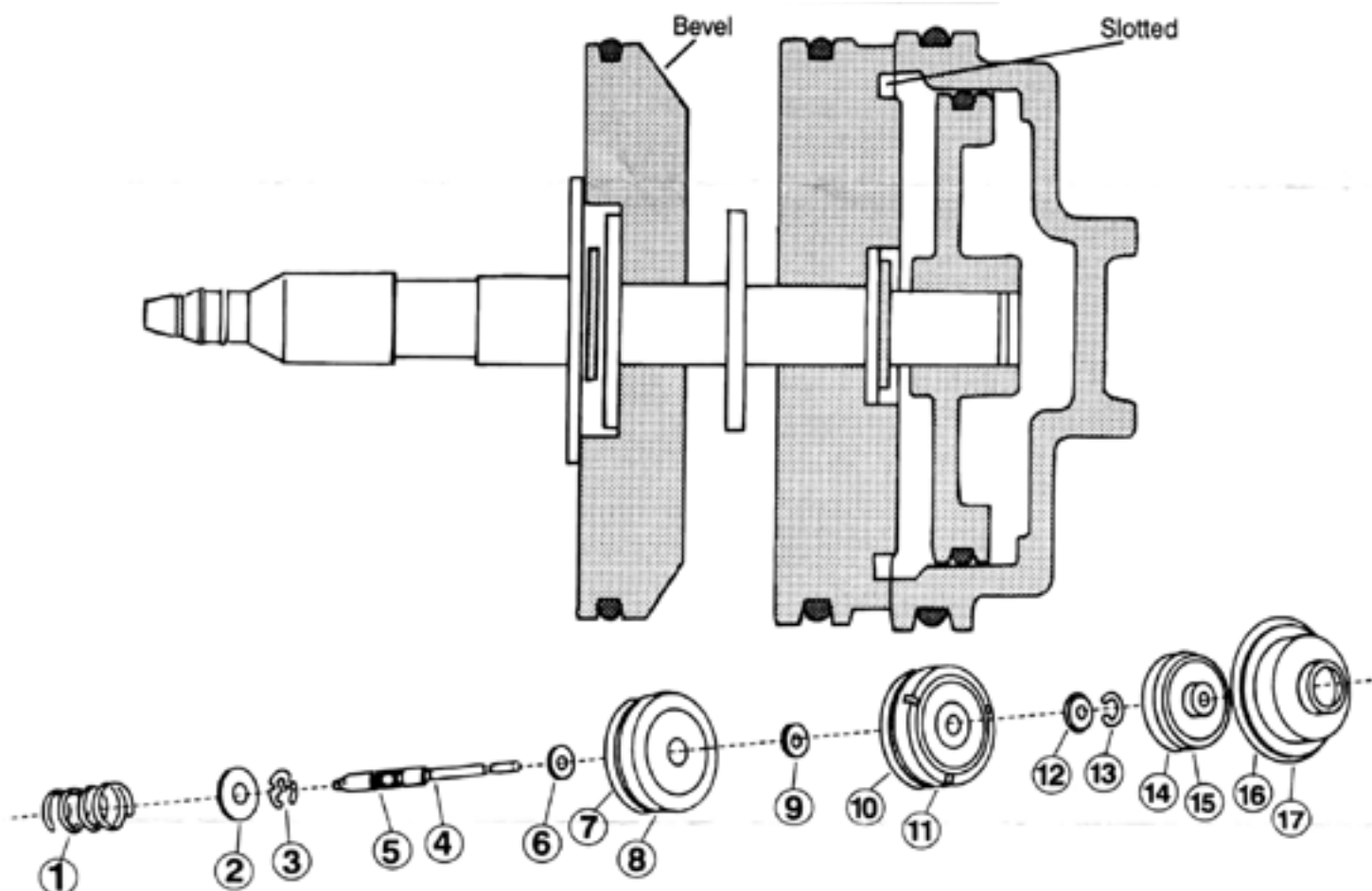

1. Servo return spring (supplied)
2. Servo retainer -largest washer (supplied)
3. Servo retaining clip (supplied)
4. Servo pin (slot)
5. Servo pin

6. 2nd apply piston washer (supplied)
7. 2nd apply piston (supplied)
8. Scarf cut Teflon seal (supplied)
9. 2nd apply piston spacer washer (supplied)
10. Outer piston (supplied)
11. O-Ring (supplied)

12. Servo apply pin washer (stock)
13. Apply pin retainer (stock)
14. 4th piston (stock)
15. 4th piston oil seal (supplied)
16. Servo cover (stock)
17. O-Ring (supplied)

1. Remove stock servo set-up from bore.

2. Disassemble the servo down to the pin.

3. Press retaining clip #3 supplied into slot #4 of pin.

4. Place one of the two smaller diameter washers #6 supplied over the cap side of the pin.

5. Install 2nd apply piston #7 supplied. Face the beveled side as illustrated.

6. Install the other smaller diameter washer #9 supplied.

7. Install the outer seal piston #10 supplied. Face the slotted side as illustrated.

8. Reinstall the stock washer #12
Note. The OE small spring IS not used in this set-up.

9. Reinstall the stock E clip #13 in slot.

10. Reinstall the stock 4th gear piston #14.

11. Insure a proper band clearance of 1/16" to 1/8". The closer to 1/16" the better. Use the extender pin cap supplied if necessary to obtain the band clearance.

12. Install Teflon seal #8 on 2nd apply piston, O-rings #11 and #17 to the outer seal piston and servo cover, then 4th gear piston seal #15 on 4th piston. All seals supplied.

Note: Use blue O-ring on servo cover.

13. Install red servo return spring #1 supplied into servo bore.

14. Place largest diameter washer #2 supplied over band side of pin using some building grease to stick washer to the 2nd apply piston.

15. Reinstall the modified servo set-up into bore.

Note: Insure all seals and O-rings are well lubricated before installation.

Optional:

Extender pin cap installation

1. This pin cap will add .150 to the length of your pin before grinding.

2. Place the cap on pin, and then use a hammer to strike the tip down until the cap bottoms out.

3. Grind the pin tip to the desired length.

